



Excellence made to order.

6800 East 163rd Street
Belton, MO 64012-5463
816 318-8000
1-800-827-3692
FAX 816-318-8100



ROADWARRIOR RAMP WEAR BAND / PLATE RETROFIT AND REPLACEMENT KIT

For RoadwarriorR ramps manufactured prior to October 2001 or with a serial number lower than RW110-0011.

Serial number format: RW (Type of product) 1 (Last digit of year) 10 (Month of year) -0011 (Sequence no.)

FM-7.5-44
Rev. H
7/23/10

This kit provides the parts necessary to retrofit or replace the wear band/plates on your RoadwarriorR Ramp. On older ramps without the current design it will be necessary to modify the rails. Read these instructions completely before starting any modifications.

Your kit you should contain the following parts (See figure 3 on page 3 for an illustrated picture):

- 2 ea Transition Wear Band/Plate
- 1 ea Transition Plate
- 1 ea Tie Rod
- 2 ea Nylon Handles
- 1 ea All thread 5/16-18 x 25 5/8 Long, SS
- 2 ea 5/16-18 X 1 21/64 HWH Rolox Screw, ZP
- 2 ea 5/16-18 x 1/2 Camtainer Nut, Torx #55
- 8 ea 1/4-20 x 5/8 Hex Head Cap Screw, SS
- 8 ea 1/4-20 Nylon Insert Stop Nut, SS

In addition to the parts listed above you will need the following tools in order to replace the wear band/plates on your ramp.

- 3/8" Socket or Wench (Not Included)
- 7/16" Socket or Wrench (Not included)
- 1/2" Socket (Not Included)
- Torque Wrench (Not Included)
- Saw for Cutting Aluminum (Not Included)
- 3/16" Allen Wrench (Not Included)
- Drill with 1/4" and 3/32" Drill Bit (Not Included)
- Torx #55 Driver (Not Included)

If you already have the current design; skip to instruction #4.

1. Modifying the rails for new wear band/plates:

- a. Remove the two 1/4" tie-rod screws with a 3/8" socket or wrench on both sides of the ramp and discard. (See figure 1).

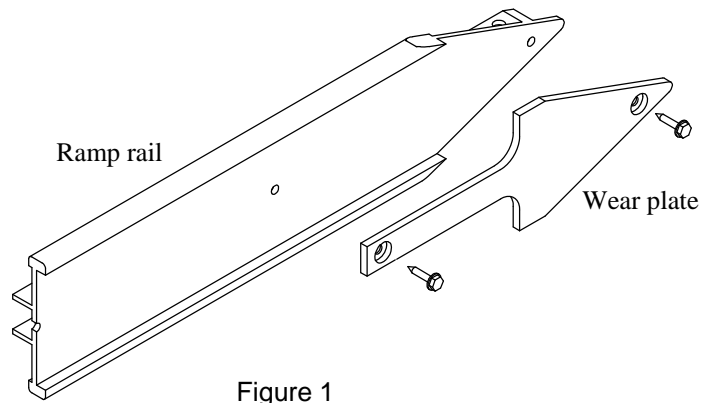

Figure 1

- b. Remove the old transition plate. Using a 3/16" Allen wrench remove the joint connector bolt on each end and discard all these parts.
- c. Remove the first casting and tie rod; discard the tie rod to avoid confusion with the new parts.
- d. Cut the tip of the ramp rails and drill hole as shown. Discard the rail tips.

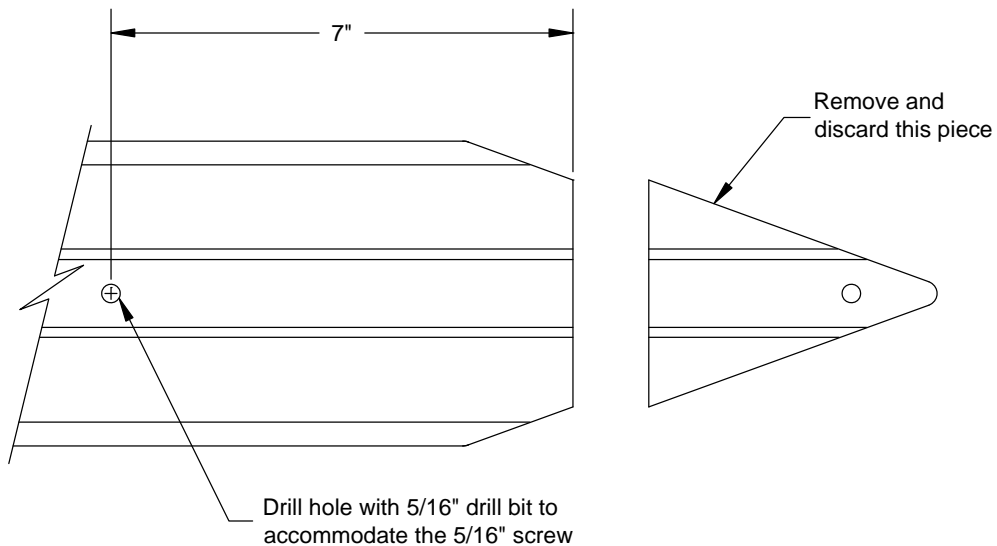

Figure 2

2. Assembly of the new transition wear/plate band:

- a. Loosely assemble the new transition wear/plate band assembly, as shown in figure 3, except for the 1/4" fasteners.

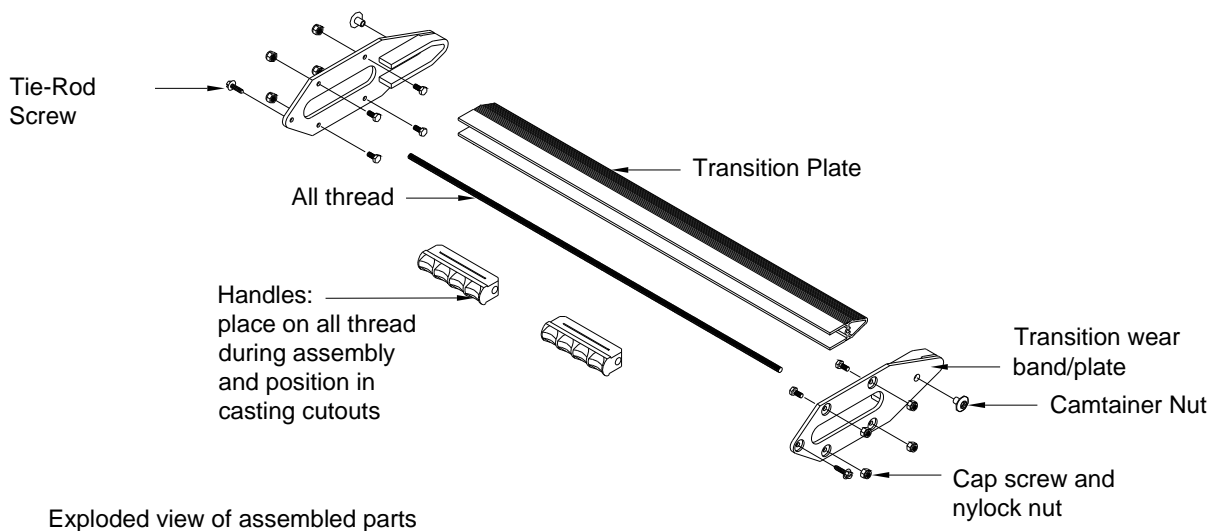

Figure 3

3. Reassembling the ramp with new transition wear band/plate assembly:

- a. Install the new tie rod between the ramp rails.
- b. Replace the casting between the ramp rails with the cut-outs toward the end of the ramp.
- c. Install the transition wear band/plate assembly to the ramp rails. Verify that end hole in the wear band/plate aligns with existing hole in the ramp rail (first tie bar location).
- d. Install the tie-rod screws using a 1/2" socket and torque wrench on each side.

CAUTION: DO NOT over-tighten the screws. Over-tightening the screws may cause them to break off within the extrusion; R•O•M recommends 19.5 ±1 ft. lbs. of torque.

- e. Match drill four 1/4" holes in each ramp rail and install the cap screws from the inside and place the stop nuts in the countersunk holes. Tighten securely.
- f. Tighten the camtainer nuts on the all thread with a Torx #55 driver.

This completes the installation of transition wear band/plate retrofit kit on your Roadwarrior Ramp. If you have any questions contact your R•O•M representative at 1-800-827-3692.

If your ramp already has the current style wear band/plate assembly; follow these steps for replacement. A layout on page 3 can be references if required.

4. **Removing the current transition wear band/plate assembly:**

- a. Use the 7/16" socket and wrench to remove the 1/4-20 screws and locknuts from each wear band/plate assembly and discard.
- b. Use the 1/2" socket to remove the tie-rod screw from the transition plate assembly.
- c. Use a rubber mallet to remove the transition plate assembly from the end of the ramp and discard.
- d. Remove the casting and first tie-rod.

5. **Reinstalling the new transition wear band/plate assembly:**

- a. Install the tie rod between the ramp rails.
- b. Replace the casting between the ramp rails with the cut-outs toward the end of the ramp.
- c. Install the transition wear/band plate assembly to the ramp rails.
- d. Install the tie-rod screws using a 1/2" socket and torque wrench on each side to retain the new wear band/plate assembly.

CAUTION: DO NOT over-tighten the screws. Over-tightening the screws may cause them to break off within the extrusion; R•O•M recommends 19.5 ±1 ft. lb. of torque.

- e. Install the cap screws from the inside and place the stop nuts in the countersunk holes. Tighten securely.
- f. Tighten the camtainer nuts on the all thread with a Torx #55 driver.

This completes the installation of transition wear band/plate kit on your Roadwarrior Ramp. If you have any questions contact your R•O•M representative at 1-800-827-3692.