

# Technical Bulletin

## Series III - MHS

Our Technical Bulletins are provided to inform you of design options, design improvements, standard sizes and changes, different models, applications, installation, operation, and maintenance.

FM-7.5-138

R•O•M is pleased to announce the addition of a new Roll-up Shutter system.

Rev D

06-24-09

### Description:

The R•O•M Roll-up Shutter Series III – MHS is a shutter developed for compartments that require minimum interference by the shutter system on the clear opening of the compartment.

### General Notes:

- Operates just as a standard Roll-up Series III shutter system.
- Requires only 1-1/2 inches of header space.
- Occupies only 4-1/2 inches of space at the top of the compartment when in its fully open position.
- Allows more compartments on a single truck to have an R•O•M shutter, thus generating a more aesthetically pleasing product.
- Requires adequate compartment depth to compartment height ratio. (See size constraints below)

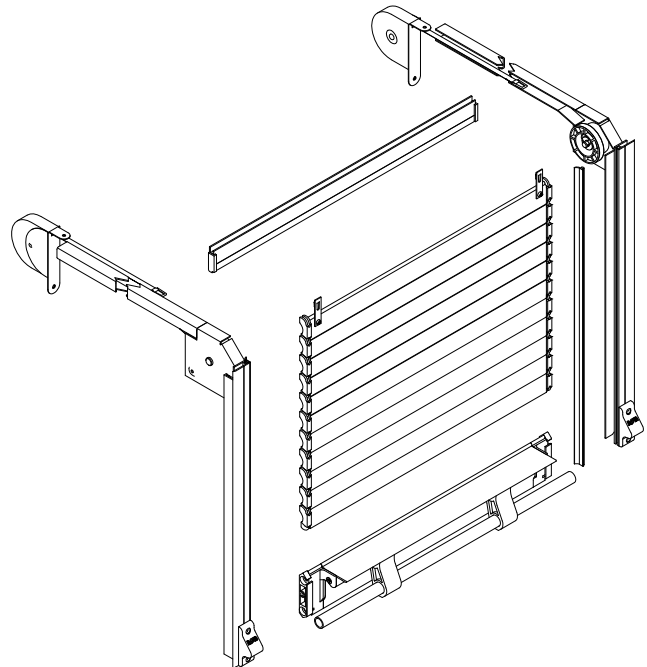

### Size Constraints:

- Maximum Internal Height = 49.0 inches
- Maximum Opening Width = 84.0 inches.
- Minimum Opening Height = 14.0 inches, however must have a Minimum Opening Width = 28.0 inches.
- Minimum Opening Width = 15.0 inches, however must have a Minimum Opening Height of = 36.0 inches.
- Minimum Internal Depth = Internal Compartment Height + 6.25 inches.

*Please provide this information to your engineering, manufacturing, sales and marketing departments, and to your dealers.*